

Norauto

FR- RIDELLES OU RÉHAUSSES DE RIDELLES

DE- BORDWÄNDE ODER BORDWANDAUFsätze

NL- ZIJWANDEN OF VERHOGINGEN VAN ZIJWANDEN

ES- BARANDILLAS O REALCES DE BARANDILLA

EN- SIDE PANELS OR SIDE PANEL RAISERS

IT- SPONDE O RIALZI PER SPONDE

PT- TAIPAIS OU EXTENSÕES DE TAIPAIS

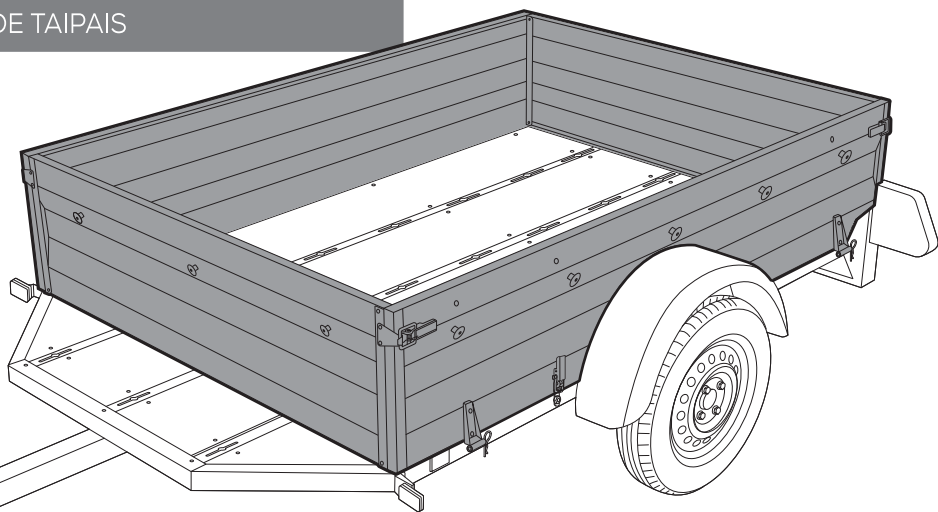

3499360017617 - 2839791 - FFL800177



FR - Notice d'utilisation / **DE** - Bedienungsanleitung
NL - Gebruiksaanwijzing / **ES** - Instrucciones
EN - Instruction manual / **IT** - Istruzioni per l'uso
PT - Instruções de utilização



40 kg



3-YEAR WARRANTY*



FR - Lisez impérativement le manuel d'utilisation avant toute utilisation du produit. / **DE** - Die handleitung verpflichtet lesen voor elke ingebruikname. / **NL** - Vor der Verwendung des Produkts ist diese Bedienungsanleitung aufmerksam durchzulesen. / **ES** - Es esencial leer el manual antes de usar el producto. / **EN** - Be sure to read the user manual before using the product. / **IT** - È essenziale leggere il manuale prima dell'uso. / **PT** - Leia o manual do utilizador antes de utilizar o produto.



FR - CONSEILS DE SÉCURITÉ
DE - SICHERHEITSRAT
NL - VEILIGHEIDSTIPS
ES - CONSEJOS DE SEGURIDAD
EN - SAFETY INSTRUCTIONS
IT - CONSIGLI DI SICUREZZA
PT - CONSELHOS DE SEGURANÇA

 **03**



FR - CONTENU
DE - INHALT
NL - INHOUD
ES - CONTENIDO
EN - CONTENT
IT - CONTENUTO
PT - CONTEÚDO

 **04**



FR - ACCESSOIRES À ACHETER
DE - ZUBEHÖR ZUM KAUFEN
NL - BIJ TE KOPEN ACCESSOIRES
ES - ACCESORIOS QUE DEBEN COMPRARSE
EN - ACCESSORIES TO BE PURCHASED
IT - ACCESSORI DA ACQUISTARE
PT - ACESSÓRIOS A ADQUIRIR

 **04**



FR - DIMENSIONS
DE - DIMENSIONEN
NL - AFMETINGEN
ES - DIMENSIONES
EN - SIZE
IT - DIMENSIONI
PT - DIMENSÕES

 **05**

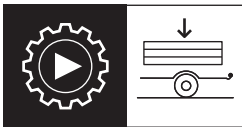

FR - INSTALLATION SUR LA REMORQUE
DE - BEFESTIGUNG AUF DEM ANHÄNGER
NL - INSTALLATIE OP DE AANHANGWAGEN
ES - INSTALACIÓN EN EL REMOLQUE
EN - ASSEMBLY ON THE TRAILER
IT - INSTALLAZIONE SUL RIMORCHIO
PT - INSTALAÇÃO NO REBOQUE

 **06 → 14**

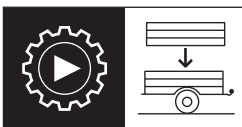

FR - AJOUT DE RÉHAUSSES
DE - HINZUFÜGEN DER AUFSÄTZE
NL - VERHOOGINGEN TOEVOEGEN
ES - AÑADIR BARANDILLAS
EN - ADDING THE SIDE PANEL RAISERS
IT - AGGIUNTA DI RIALZI
PT - ADICIONAR EXTENSÕES

 **15 → 23**



FR - CONSEILS DE SÉCURITÉ
DE - SICHERHEITSRAT
NL - VEILIGHEIDSTIPS
ES - CONSEJOS DE SEGURIDAD
EN - SAFETY INSTRUCTIONS
IT - CONSIGLI DI SICUREZZA
PT - CONSELHOS DE SEGURANÇA

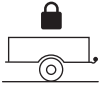

FR - Les ridelles et fermetures doivent toujours être fermées pendant la circulation.
DE - Die Bordwände und Verschlüsse müssen im Strassenverkehr immer geschlossen sein.
NL - Zijwanden en sluitingen moeten altijd gesloten zijn tijdens het rijden.
ES - Las barandillas y los cierres siempre deben estar cerrados durante la circulación.
EN - Side panels and closures must always be closed when driving.
IT - Le sponde e le chiusure devono essere sempre chiuse durante la circolazione.
PT - Os taipais e os fechos devem estar sempre fechados durante a circulação.



FR - La masse des options ou accessoires diminue la charge utile de votre remorque. Exemple : un jeu de ridelle pour votre remorque pèse environ 40 kg, un jeu de ridelle grillagée pèse environ 28 kg.
DE - Das Gewicht von Optionen oder Zubehör verringert die Nutzlast Ihres Anhängers. Beispiel: Ein Satz Bordwände für Ihren Anhänger wiegt ca. 40 kg, ein Satz Gitteraufsatz wiegt ca. 28 kg.
NL - Het gewicht van opties of accessoires vermindert het laadvermogen van je aanhangwagen. Bijvoorbeeld: een set zijwanden voor je aanhangwagen weegt ongeveer 40 kg, een set loofrekken weegt ongeveer 28 kg.
ES - El peso de las opciones o accesorios reduce la carga útil de su remolque. Por ejemplo: un juego de barandillas para tu remolque pesa unos 40 kg, un juego de rejilla pesa unos 28 kg.
EN - The weight of options or accessories reduces the payload of your trailer. For example: a set of side panels for your trailer weighs around 40 kg, a set of grid side panels weighs around 28 kg.
IT - Il peso delle configurazioni o degli accessori riduce il carico utile del rimorchio. Ad esempio: un set di sponde per il rimorchio pesa circa 40 kg, un set di sponde grigliate pesa circa 28 kg.
PT - O peso das opções ou acessórios reduz a carga útil do seu reboque. Por exemplo: um conjunto de taipais de rede para a plataforma pesa cerca de 40 kg, um conjunto de Grelha dupla de rede pesa cerca de 28 kg.



FR - Configuration interdite (Ne jamais mettre plus de 2 jeux de réhausse l'une sur l'autre).
DE - Konfiguration verboten (Nie mehr als 2 Sätze der Aufsätze aufeinander platzieren).
NL - Verboden configuratie (plaats nooit meer dan 2 sets zijwanden boven elkaar).
ES - Configuración prohibida (nunca se deben utilizar más de 2 juegos de realce, uno encima del otro).
EN - Set-up not allowed (Never put more than 2 sets of extensions on top of each other).
IT - Configurazione vietata (Non mettere mai più di 2 set di rialzi uno sull'altro).
PT - Configuração proibida (nunca coloque mais de 2 conjuntos de extensões um em cima do outro).



FR - CONTENU
DE - INHALT
NL - INHOUD
ES - CONTENIDO
EN - CONTENT
IT - CONTENUTO
PT - CONTEÚDO

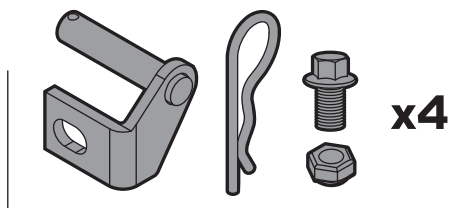
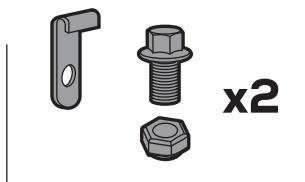
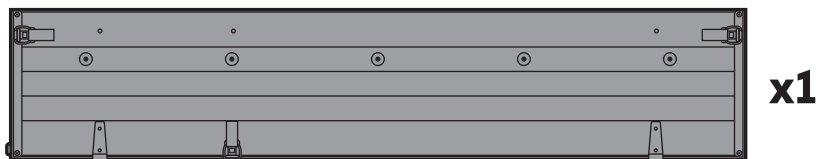

FR - ACCESSOIRES À ACHETER
DE - ZUBEHÖR ZUM KAUFEN
NL - BIJ TE KOPEN ACCESSOIRES
ES - ACCESORIOS QUE DEBEN COMPRARSE
EN - ACCESSORIES TO BE PURCHASED
IT - ACCESSORI DA ACQUISTARE
PT - ACESSÓRIOS A ADQUIRIR

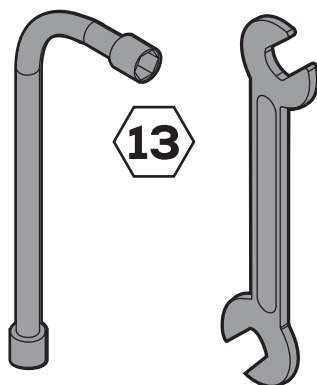



FR - DIMENSIONS
DE - DIMENSIONEN
NL - AFMETINGEN
ES - DIMENSIONES
EN - SIZE
IT - DIMENSIONI
PT - DIMENSÕES

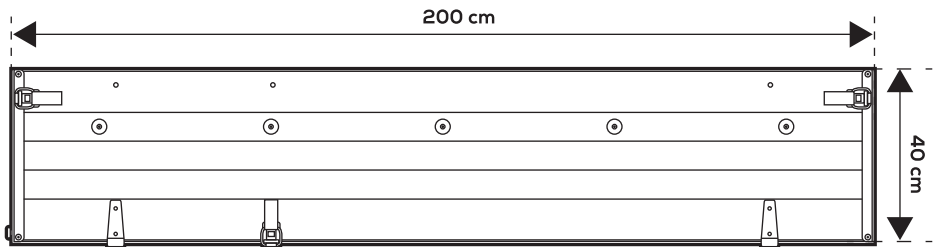
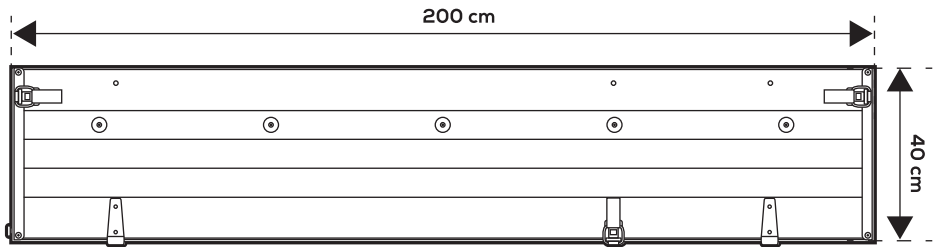
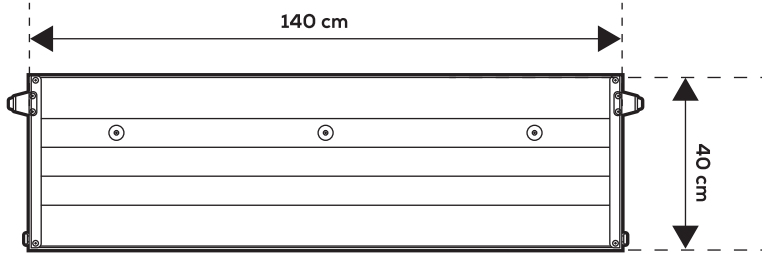

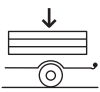

FR - INSTALLATION SUR LA REMORQUE
DE - BEFESTIGUNG AUF DEM ANHÄNGER
NL - INSTALLATIE OP DE AANHANGWAGEN
ES - INSTALACIÓN EN EL REMOLQUE
EN - ASSEMBLY ON THE TRAILER
IT - INSTALLAZIONE SUL RIMORCHIO
PT - INSTALAÇÃO NO REBOQUE

1

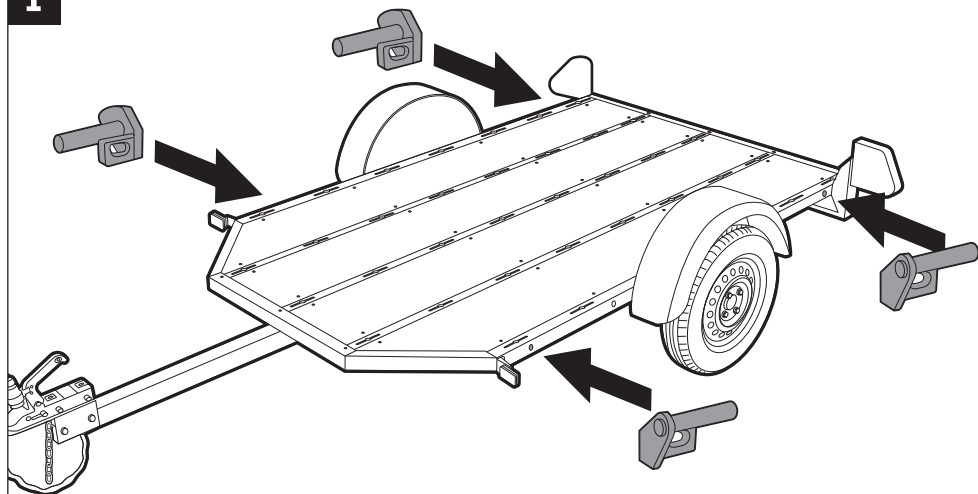

1

x4

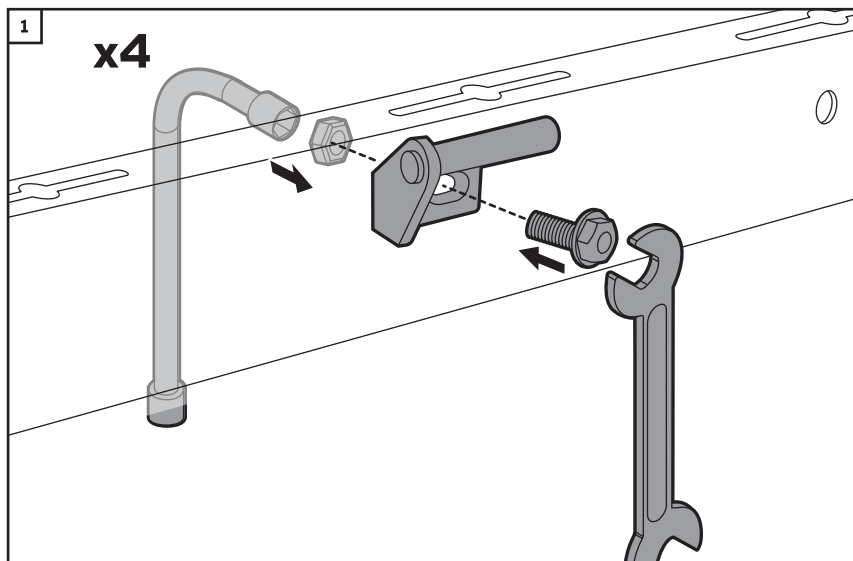

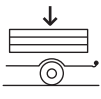

FR - INSTALLATION SUR LA REMORQUE
DE - BEFESTIGUNG AUF DEM ANHÄNGER
NL - INSTALLATIE OP DE AANHANGWAGEN
ES - INSTALACIÓN EN EL REMOLQUE
EN - ASSEMBLY ON THE TRAILER
IT - INSTALLAZIONE SUL RIMORCHIO
PT - INSTALAÇÃO NO REBOQUE

2

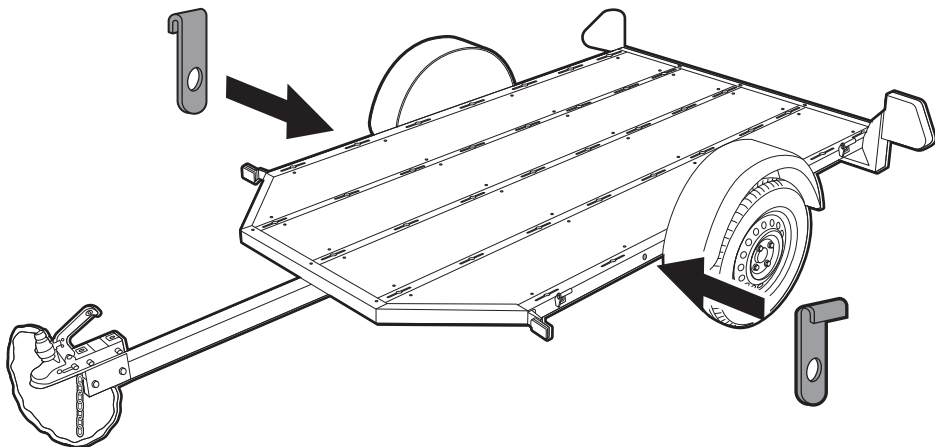

1

x2

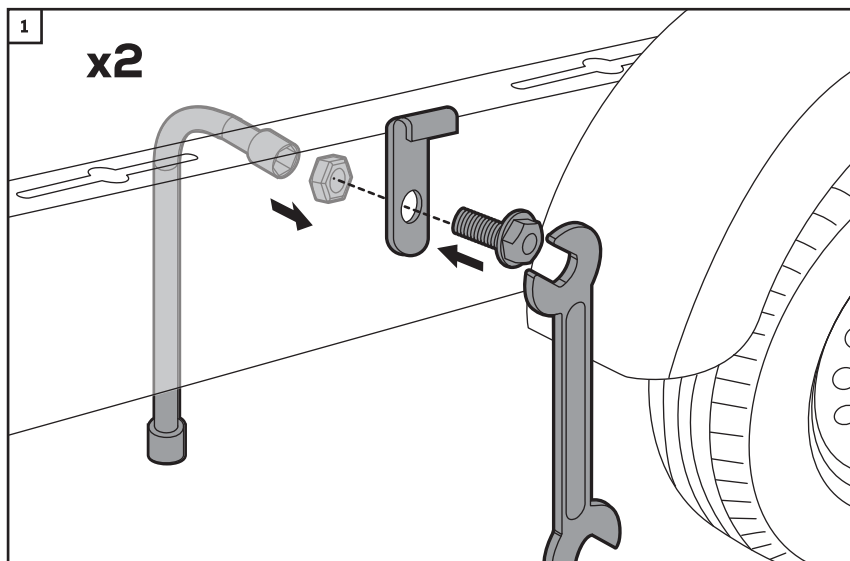



FR - INSTALLATION SUR LA REMORQUE
DE - BEFESTIGUNG AUF DEM ANHÄNGER
NL - INSTALLATIE OP DE AANHANGWAGEN
ES - INSTALACIÓN EN EL REMOLQUE
EN - ASSEMBLY ON THE TRAILER
IT - INSTALLAZIONE SUL RIMORCHIO
PT - INSTALAÇÃO NO REBOQUE

3

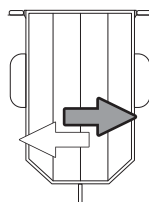
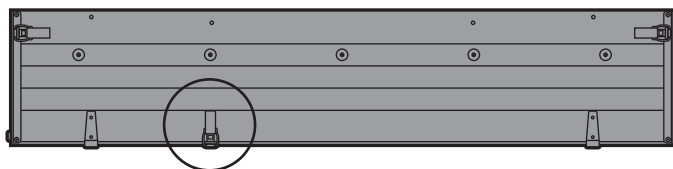

1

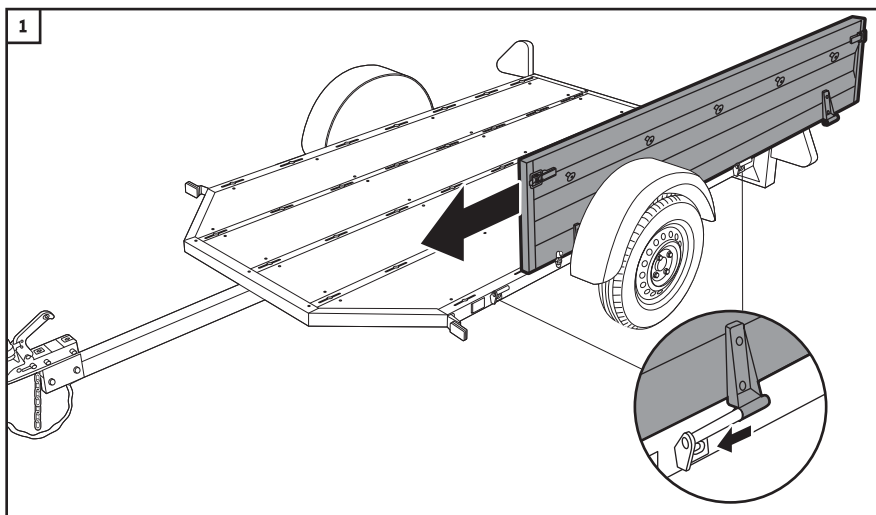

2

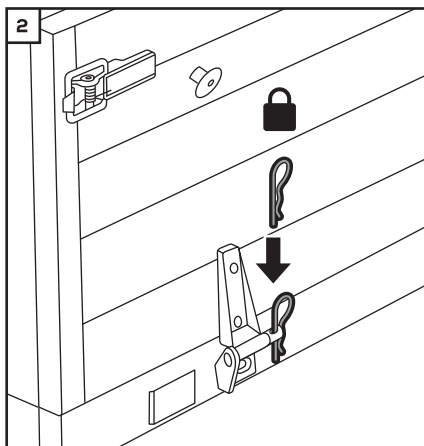

3

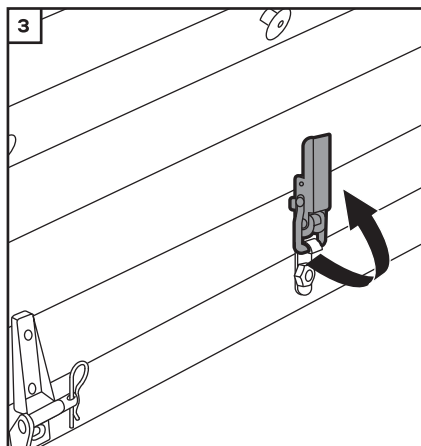



FR - INSTALLATION SUR LA REMORQUE
DE - BEFESTIGUNG AUF DEM ANHÄNGER
NL - INSTALLATIE OP DE AANHANGWAGEN
ES - INSTALACIÓN EN EL REMOLQUE
EN - ASSEMBLY ON THE TRAILER
IT - INSTALLAZIONE SUL RIMORCHIO
PT - INSTALAÇÃO NO REBOQUE

4

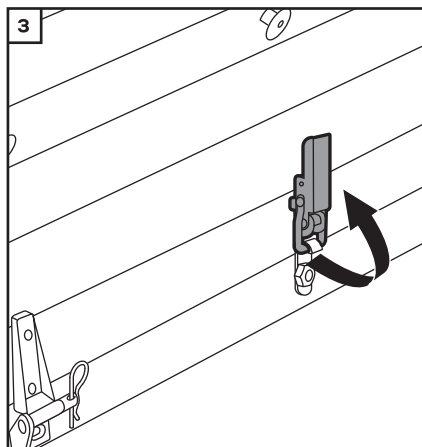
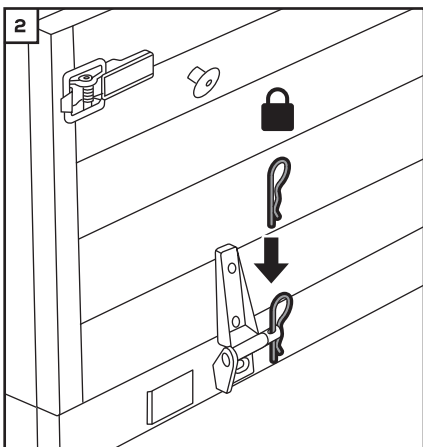
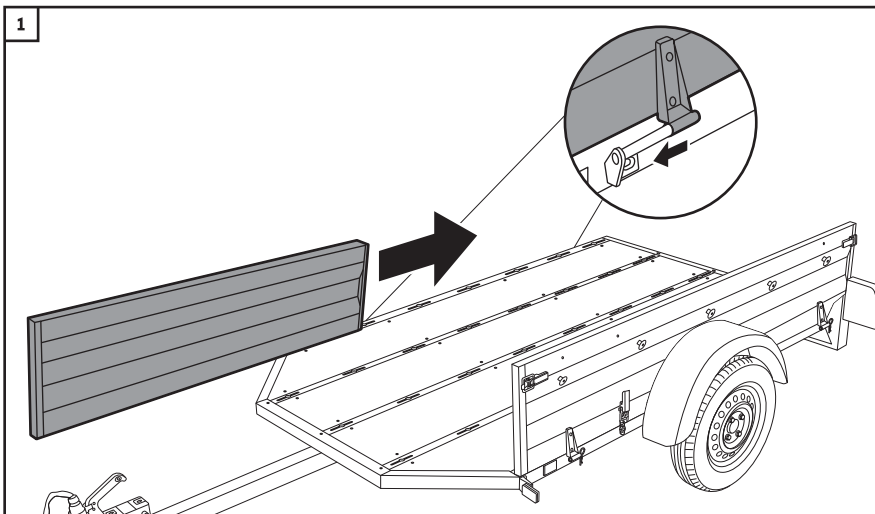
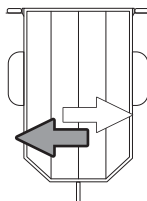

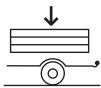

FR - INSTALLATION SUR LA REMORQUE
DE - BEFESTIGUNG AUF DEM ANHÄNGER
NL - INSTALLATIE OP DE AANHANGWAGEN
ES - INSTALACIÓN EN EL REMOLQUE
EN - ASSEMBLY ON THE TRAILER
IT - INSTALLAZIONE SUL RIMORCHIO
PT - INSTALAÇÃO NO REBOQUE

5

1

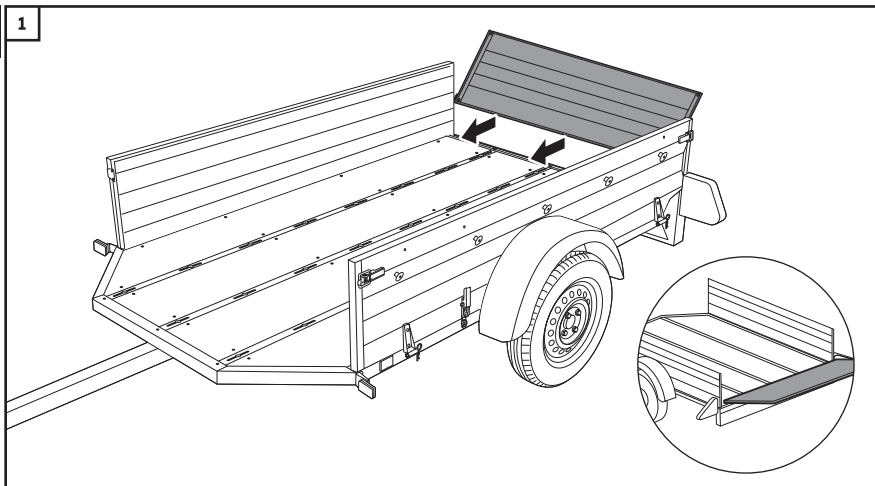

2

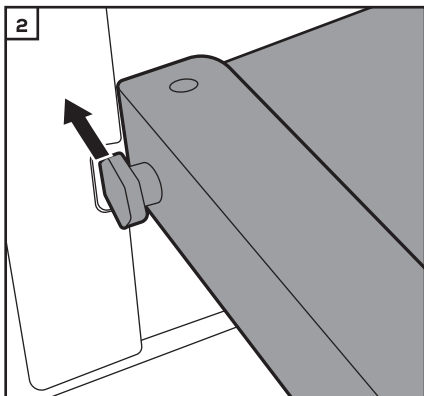

3

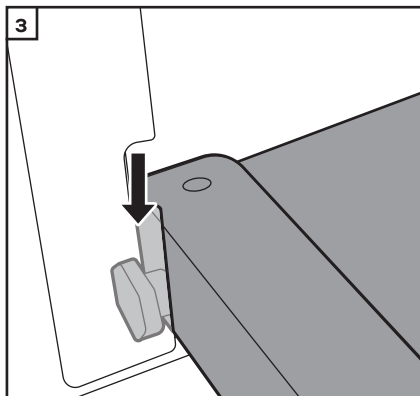

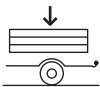

FR - INSTALLATION SUR LA REMORQUE
DE - BEFESTIGUNG AUF DEM ANHÄNGER
NL - INSTALLATIE OP DE AANHANGWAGEN
ES - INSTALACIÓN EN EL REMOLQUE
EN - ASSEMBLY ON THE TRAILER
IT - INSTALLAZIONE SUL RIMORCHIO
PT - INSTALAÇÃO NO REBOQUE

6 1

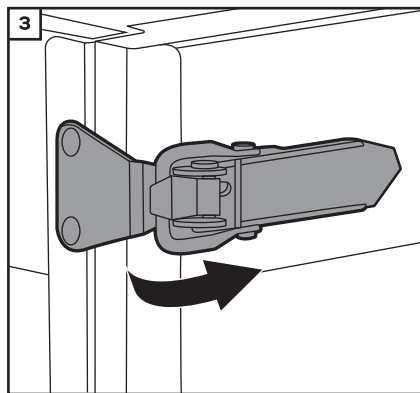
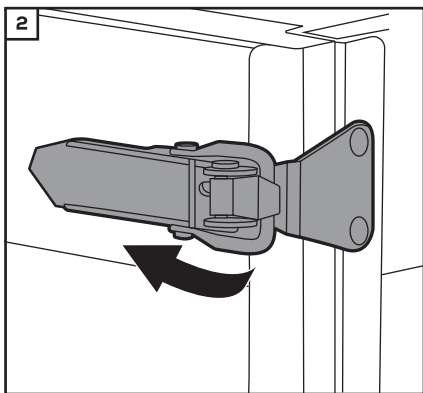
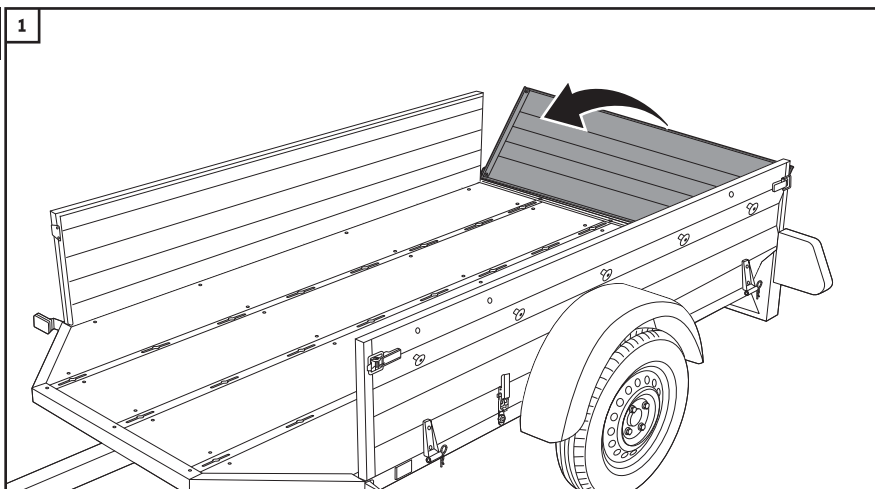

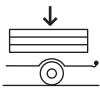

FR - INSTALLATION SUR LA REMORQUE
DE - BEFESTIGUNG AUF DEM ANHÄNGER
NL - INSTALLATIE OP DE AANHANGWAGEN
ES - INSTALACIÓN EN EL REMOLQUE
EN - ASSEMBLY ON THE TRAILER
IT - INSTALLAZIONE SUL RIMORCHIO
PT - INSTALAÇÃO NO REBOQUE

7

1

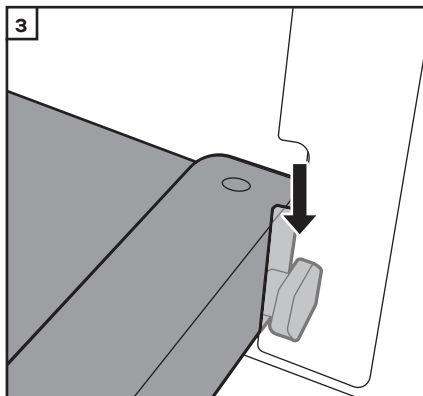
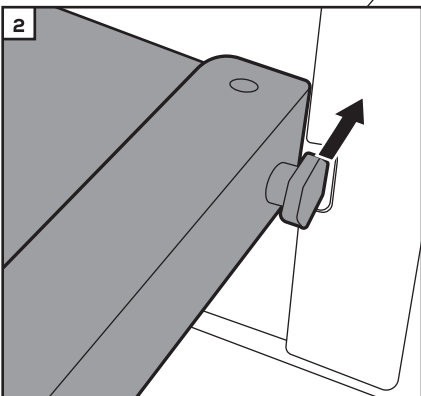
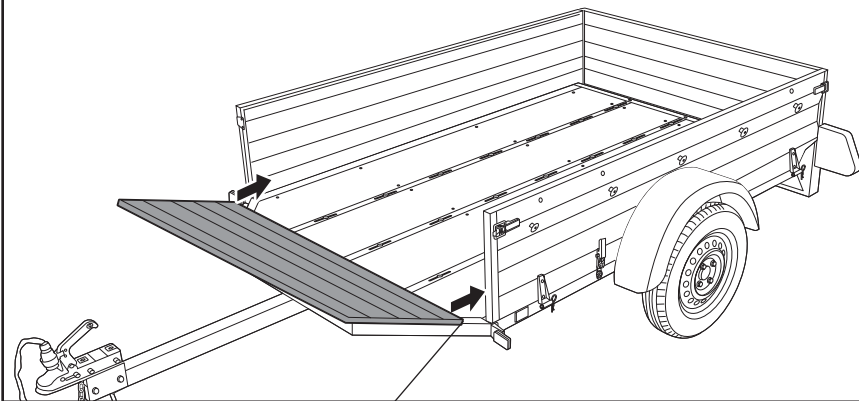

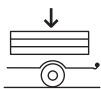

FR - INSTALLATION SUR LA REMORQUE
DE - BEFESTIGUNG AUF DEM ANHÄNGER
NL - INSTALLATIE OP DE AANHANGWAGEN
ES - INSTALACIÓN EN EL REMOLQUE
EN - ASSEMBLY ON THE TRAILER
IT - INSTALLAZIONE SUL RIMORCHIO
PT - INSTALAÇÃO NO REBOQUE

8

1

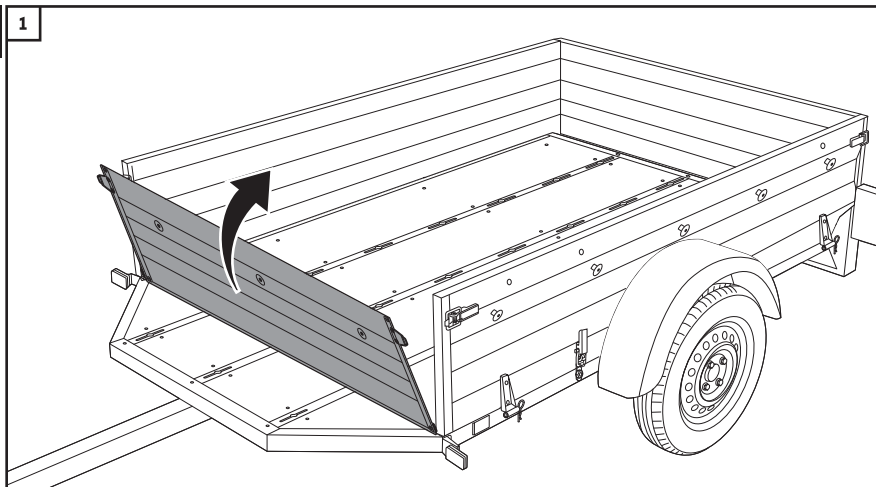

2

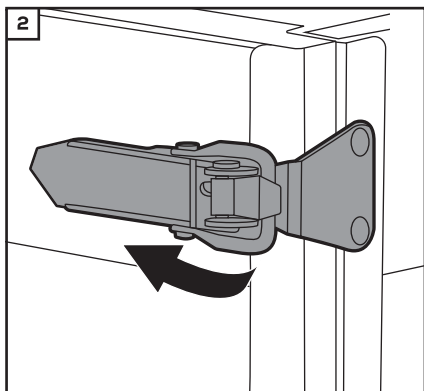

3

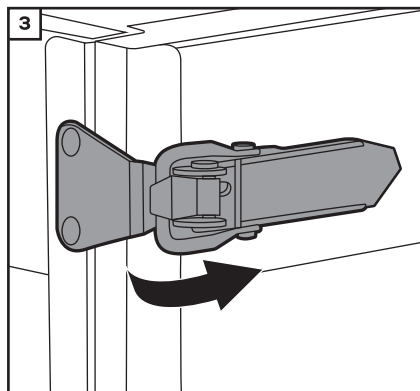

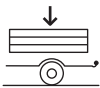

FR - OUVERTURE DES RIDELLES
DE - ÖFFNEN DER BORDWÄNDE
NL - OPENEN VAN DE DE ZIJWANDEN
ES - APERTURA DE LAS BARANDILLAS
EN - OPENING THE SIDE PANELS
IT - APERTURA DELLE SPONDE
PT - ABERTURA DOS TAIPAIS

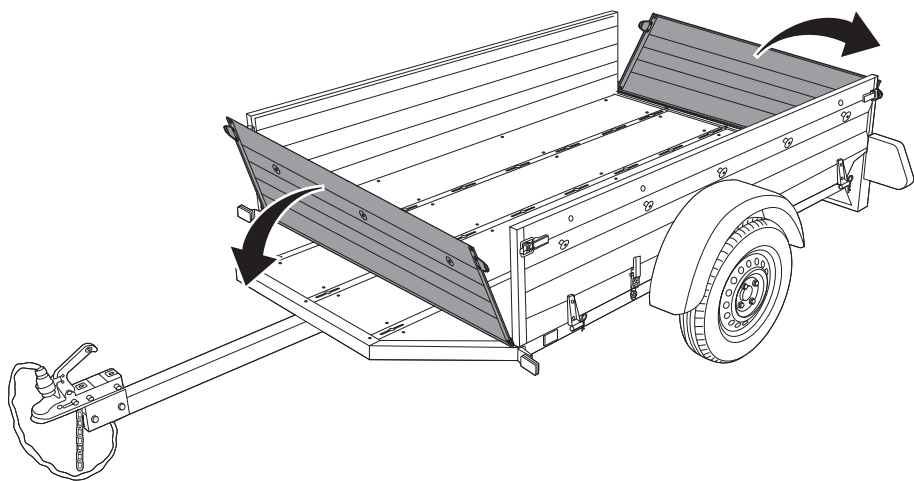
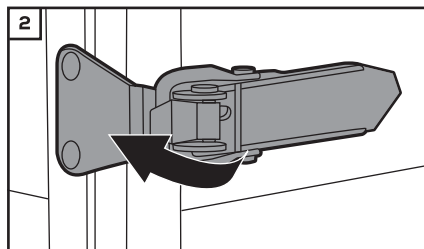
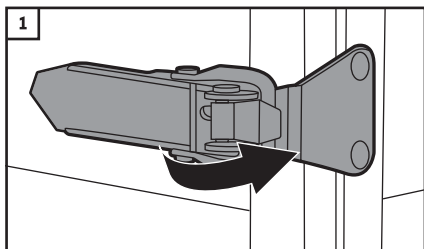
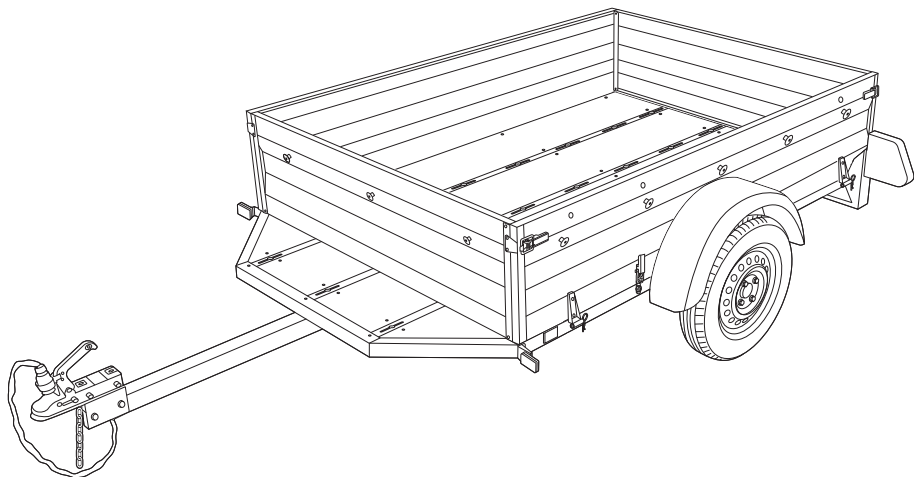

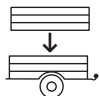

FR - AJOUT DE RÉHAUSSES
DE - HINZUFÜGEN DER AUFSÄTZE
NL - VERHOOGEN TOEVOEGEN
ES - AÑADIR BARANDILLAS
EN - ADDING THE SIDE PANEL RAISERS
IT - AGGIUNTA DI RIALZI
PT - ADICIONAR EXTENSÕES

1

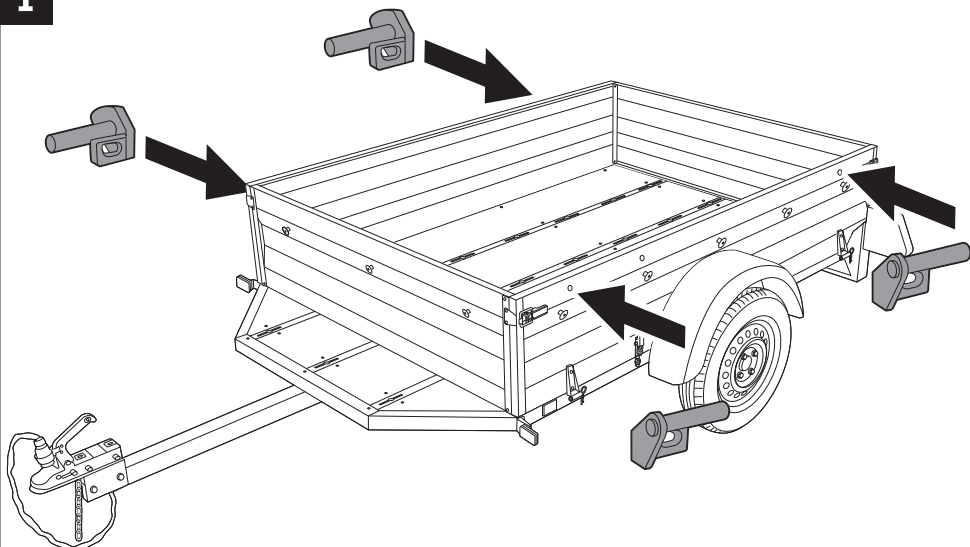

1

x4

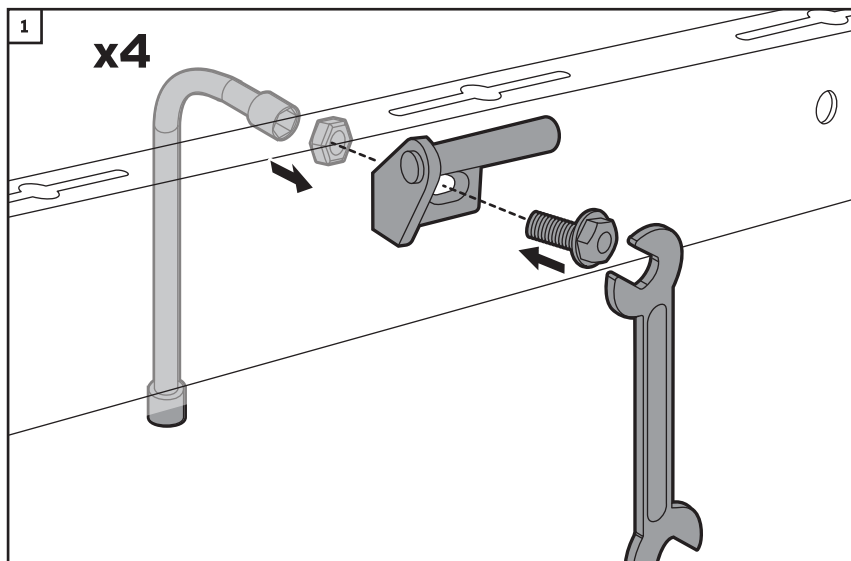

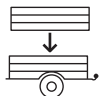

FR - AJOUT DE RÉHAUSSES
DE - HINZUFÜGEN DER AUFSÄTZE
NL - VERHOOGEN TOEVOEGEN
ES - AÑADIR BARANDILLAS
EN - ADDING THE SIDE PANEL RAISERS
IT - AGGIUNTA DI RIALZI
PT - ADICIONAR EXTENSÕES

2

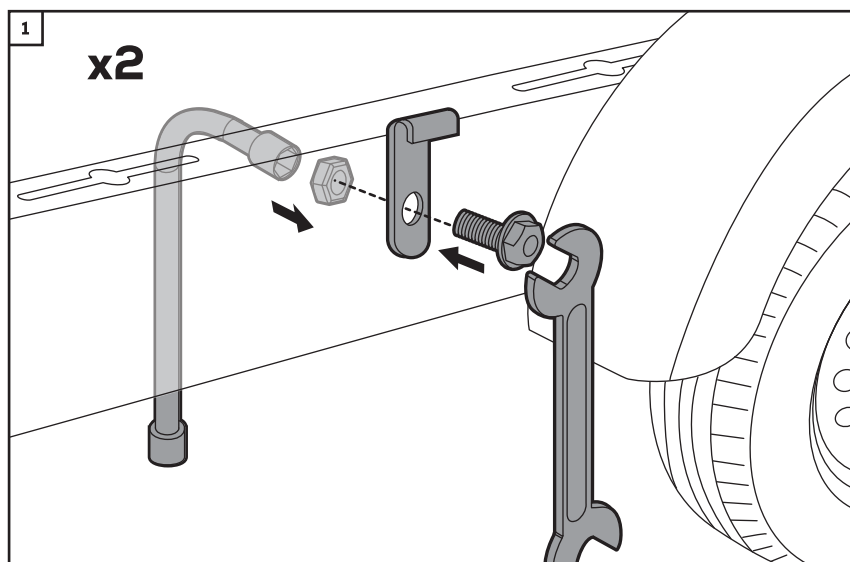
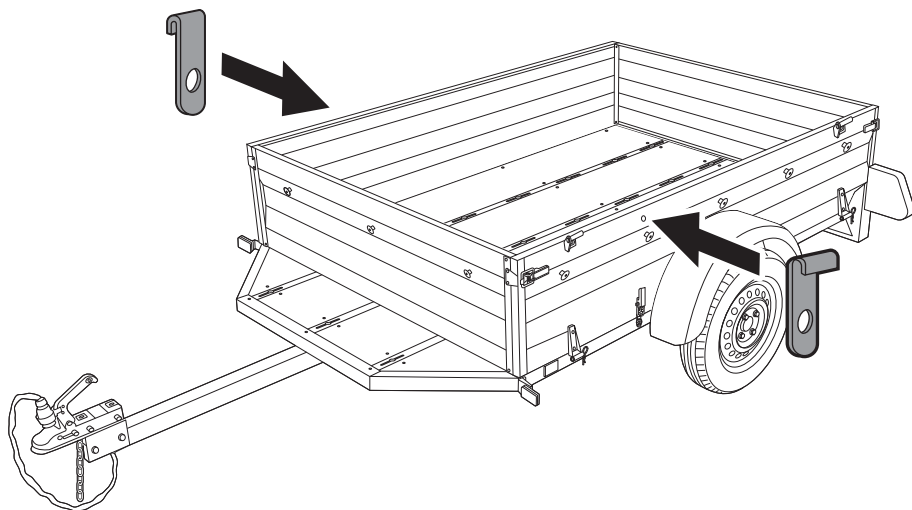



FR - AJOUT DE RÉHAUSSES
DE - HINZUFÜGEN DER AUFSÄTZE
NL - VERHOOGEN TOEVOEGEN
ES - AÑADIR BARANDILLAS
EN - ADDING THE SIDE PANEL RAISERS
IT - AGGIUNTA DI RIALZI
PT - ADICIONAR EXTENSÕES

3

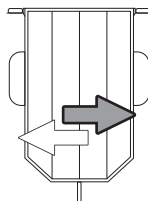
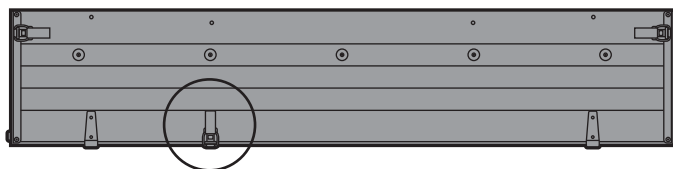

1

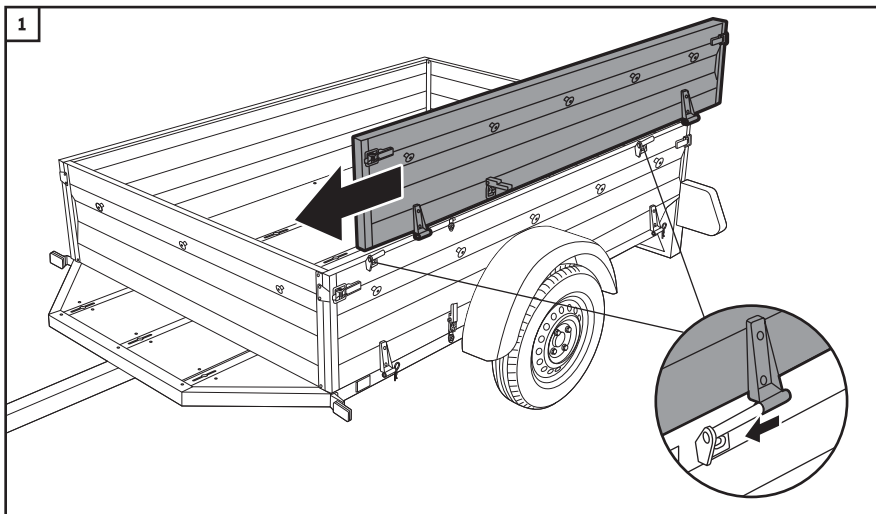

2

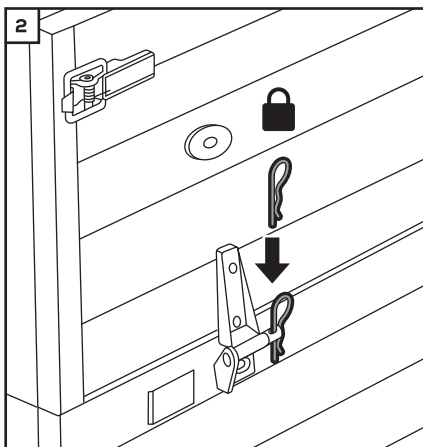

3

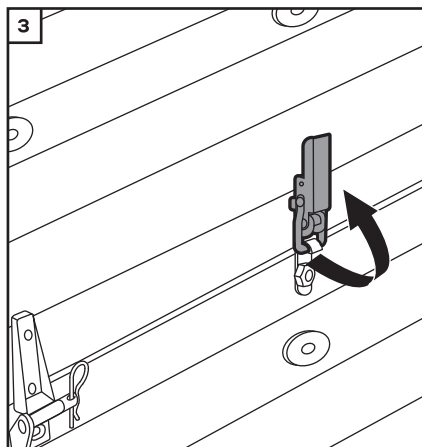

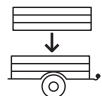

FR - AJOUT DE RÉHAUSSES
DE - HINZUFÜGEN DER AUFSÄTZE
NL - VERHOOGEN TOEVOEGEN
ES - AÑADIR BARANDILLAS
EN - ADDING THE SIDE PANEL RAISERS
IT - AGGIUNTA DI RIALZI
PT - ADICIONAR EXTENSÕES

4

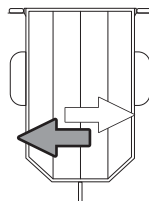

1

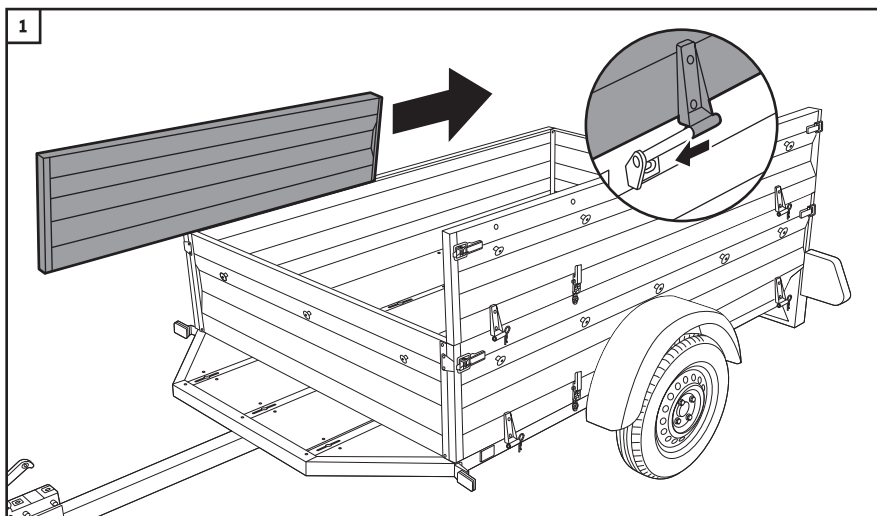

2

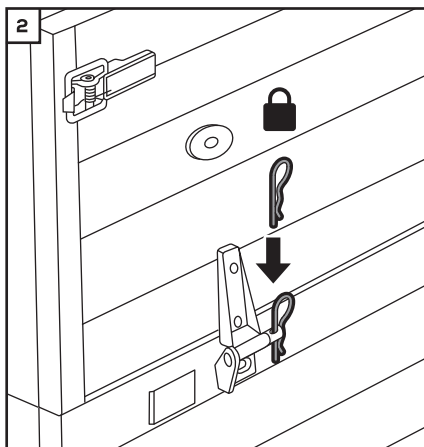

3

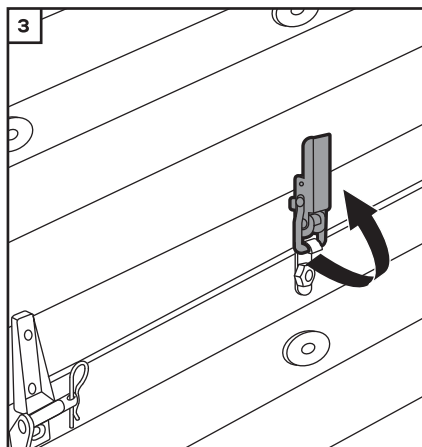



FR - AJOUT DE RÉHAUSSES
DE - HINZUFÜGEN DER AUFSÄTZE
NL - VERHOGENEN TOEVOEGEN
ES - AÑADIR BARANDILLAS
EN - ADDING THE SIDE PANEL RAISERS
IT - AGGIUNTA DI RIALZI
PT - ADICIONAR EXTENSÕES

5

1

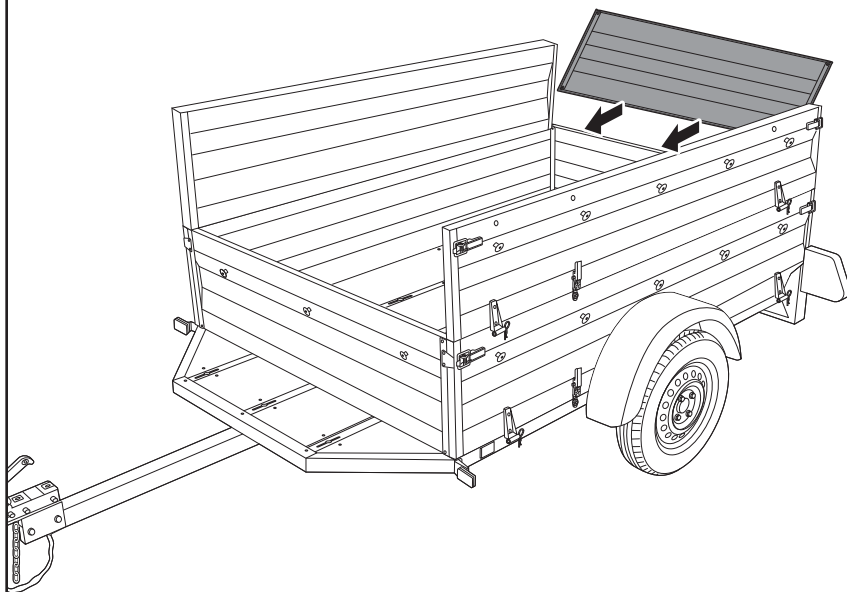

2

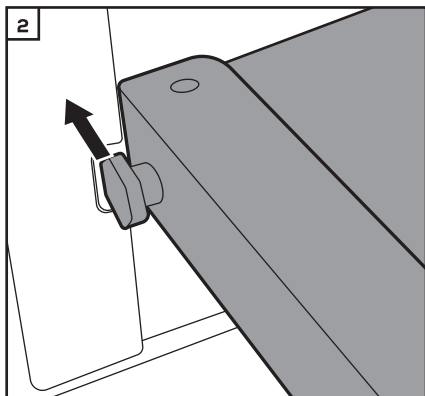

3

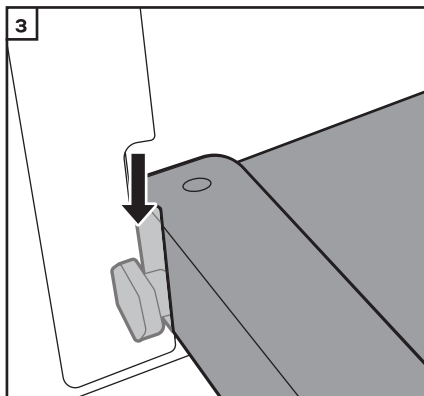

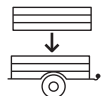

FR - AJOUT DE RÉHAUSSES
DE - HINZUFÜGEN DER AUFSÄTZE
NL - VERHOOGEN TOEVOEGEN
ES - AÑADIR BARANDILLAS
EN - ADDING THE SIDE PANEL RAISERS
IT - AGGIUNTA DI RIALZI
PT - ADICIONAR EXTENSÕES

6 1

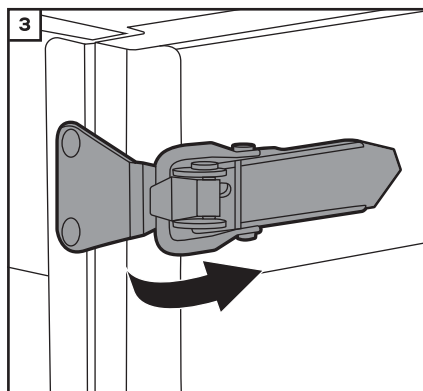
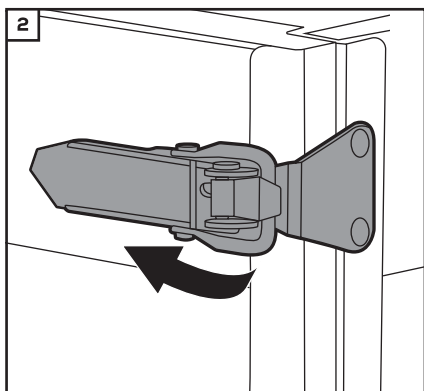
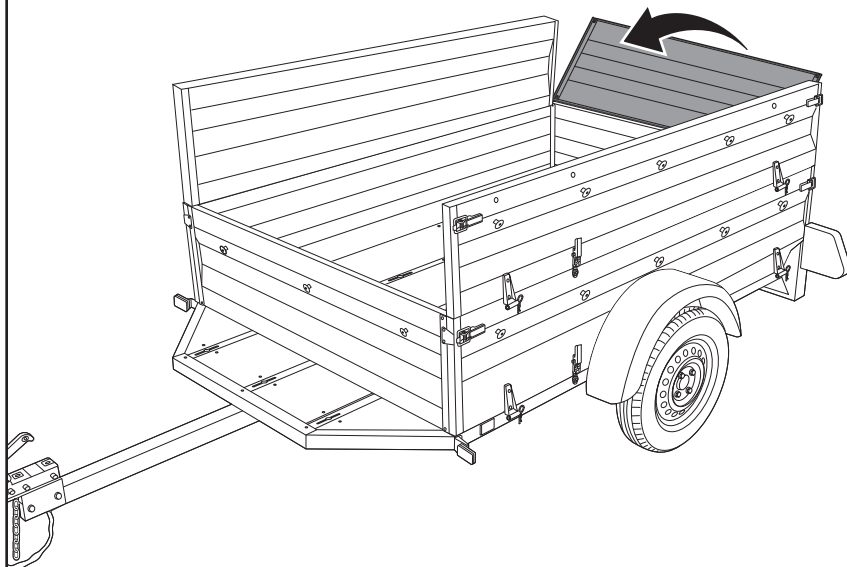

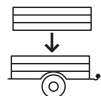

FR - AJOUT DE RÉHAUSSES
DE - HINZUFÜGEN DER AUFSÄTZE
NL - VERHOOGEN TOEVOEGEN
ES - AÑADIR BARANDILLAS
EN - ADDING THE SIDE PANEL RAISERS
IT - AGGIUNTA DI RIALZI
PT - ADICIONAR EXTENSÕES

7

1

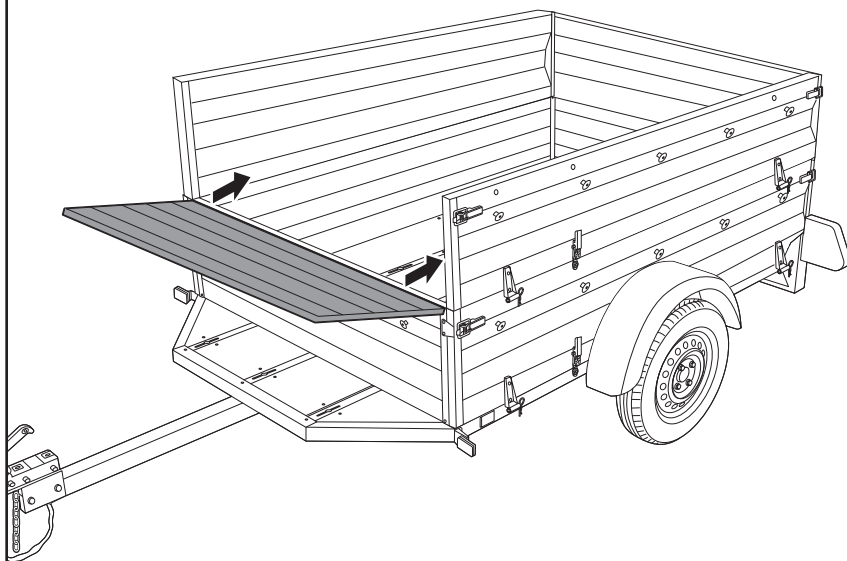

2

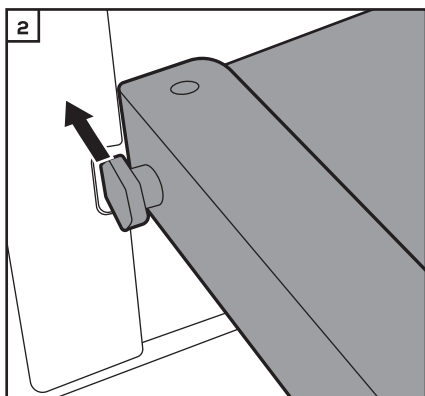

3

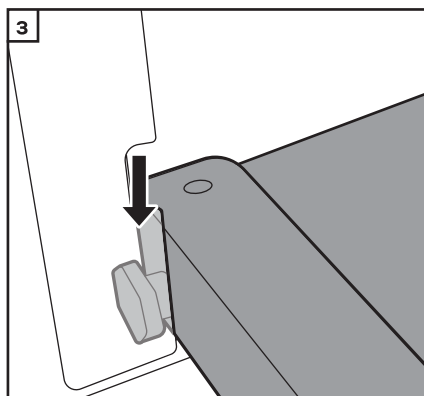

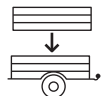

FR - AJOUT DE RÉHAUSSES
DE - HINZUFÜGEN DER AUFSÄTZE
NL - VERHOOGEN TOEVOEGEN
ES - AÑADIR BARANDILLAS
EN - ADDING THE SIDE PANEL RAISERS
IT - AGGIUNTA DI RIALZI
PT - ADICIONAR EXTENSÕES

8

1

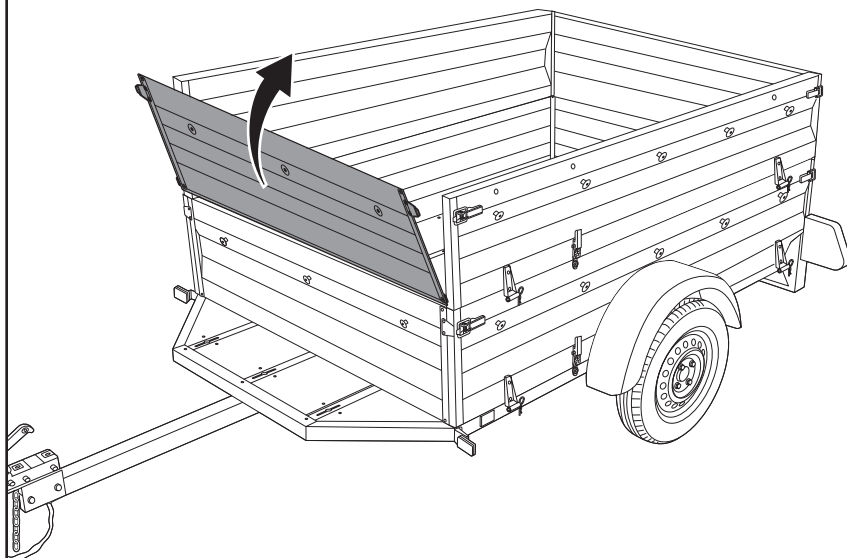

2

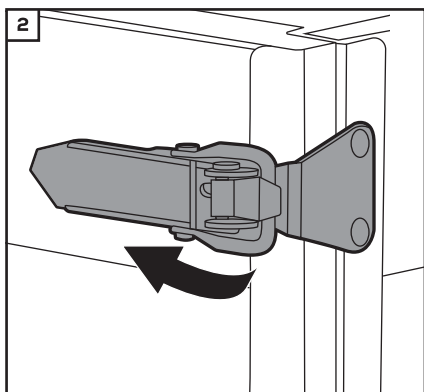

3

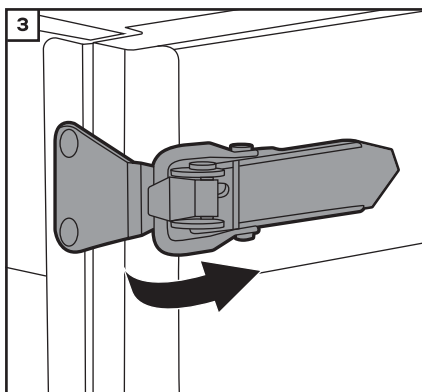



FR - AJOUT DE RÉHAUSSES
DE - HINZUFÜGEN DER AUFSÄTZE
NL - VERHOGEN EN TOEVOEGEN
ES - AÑADIR BARANDILLAS
EN - ADDING THE SIDE PANEL RAISERS
IT - AGGIUNTA DI RIALZI
PT - ADICIONAR EXTENSÕES

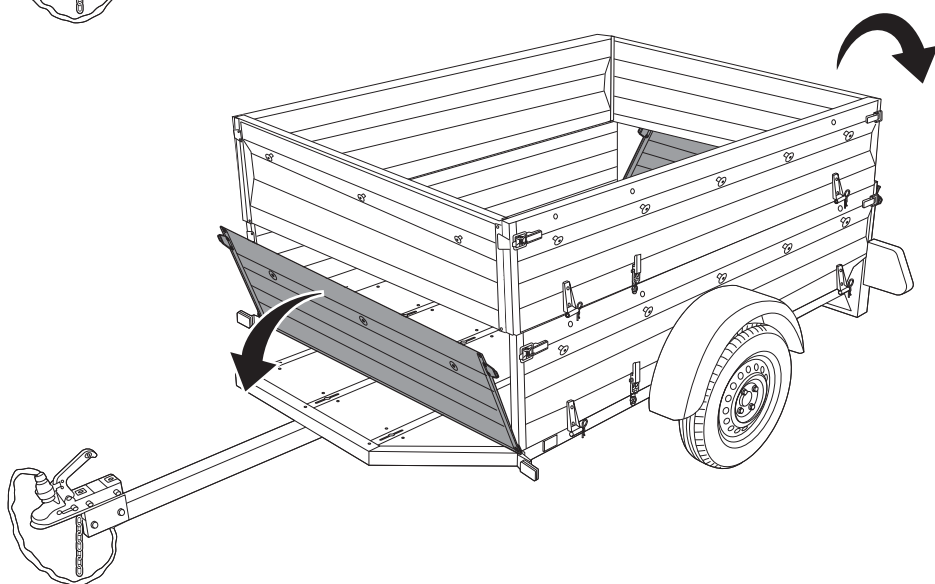
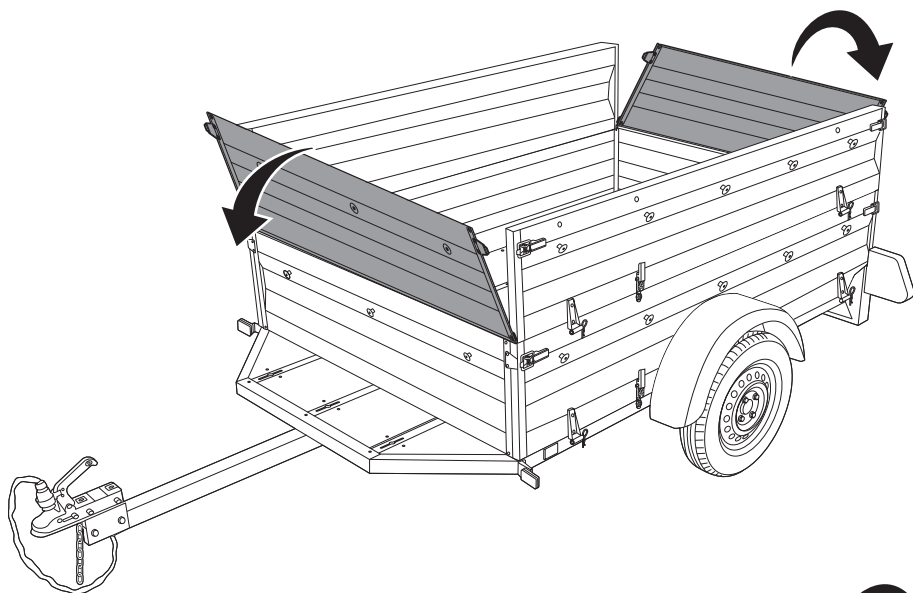

Norauto
2A boulevard Van Gogh 59650 Villeneuve d'Ascq France
www.norauto.com
Made in France

