

309

MERCEDES GLC, 5-portes/Türen/doors, 15-

Diagram illustrating weight distribution on the roof rack. A 69 Kg load is placed on top of a 6 Kg rack, totaling 75 Kg. A warning triangle is shown next to a car with a roof rack. A speedometer graphic indicates a maximum speed of 80 km/h.

Diagram showing the parts list for the roof rack installation. An open box is shown above the parts. The parts are:

- 011: 4 pieces
- 024: 4 pieces
- 022: 4 pieces
- 021: 4 pieces

A small inset image shows the Norauto XX logo and a reference to the 75 Kg weight limit.

A + **B**

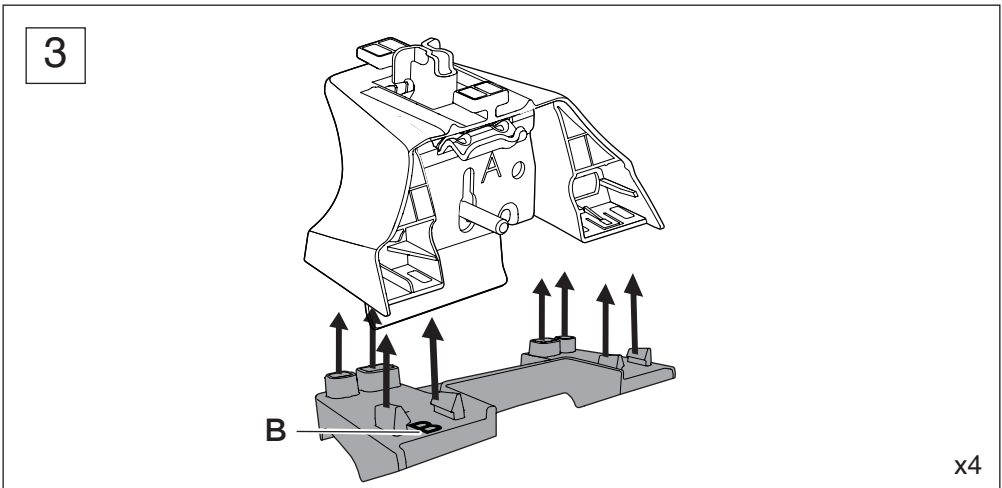
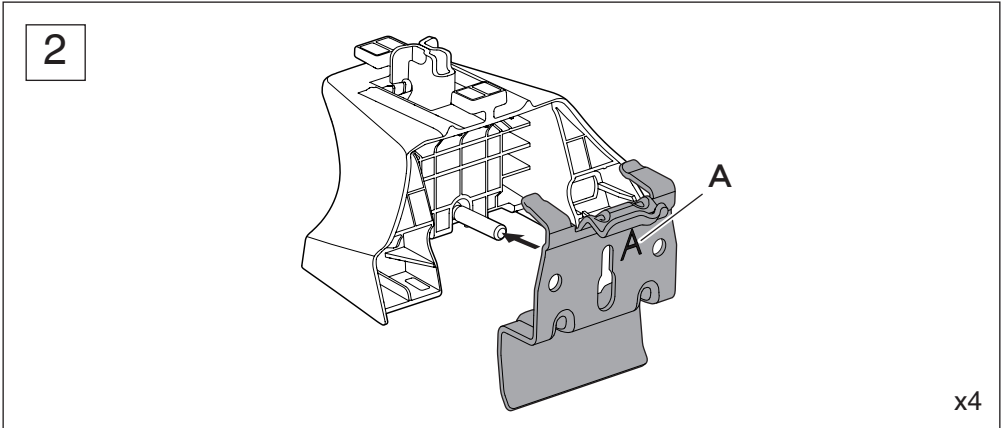
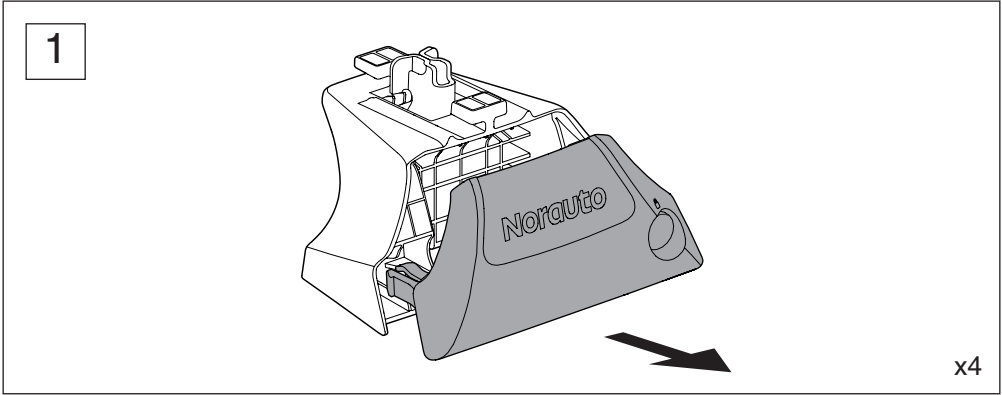

4

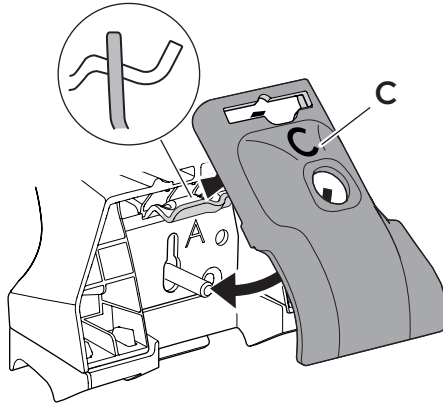

x4

5

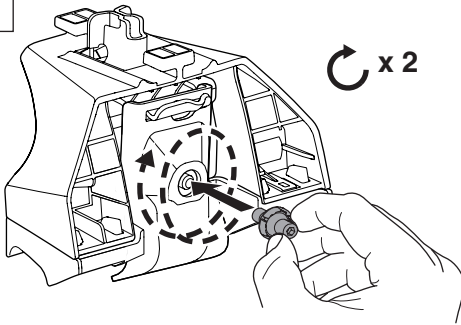

x4

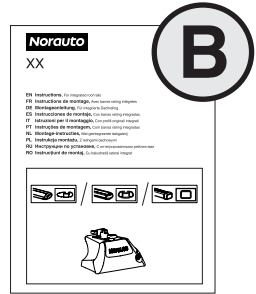

i

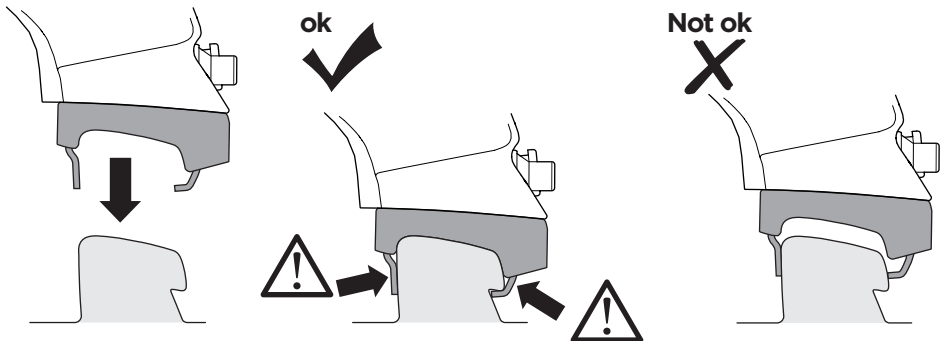

NORAUTO

511/589 rue des Seringats
59262 Sainghin-en-Mélantois
FRANCE