

# Kit 1543

RENAULT Scénic III, 5-dr MPV, 09–

RENAULT Grand Scénic III, 5-dr MPV, 09–

480R  
754

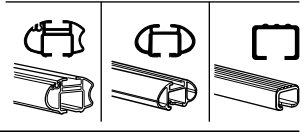
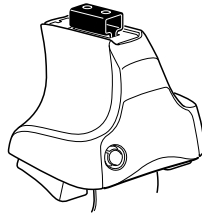

480

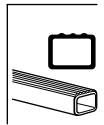
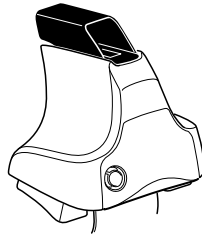

750

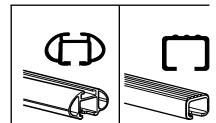
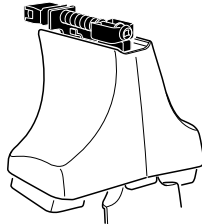

**Kit**



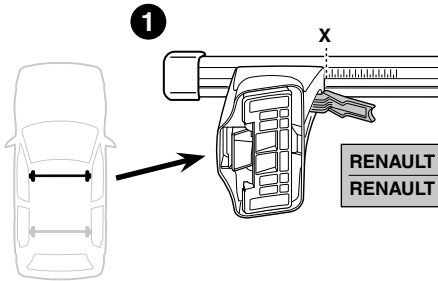

|   | X    |
|---|------|
| RENAULT Scénic III, 5-dr MPV, 09–       | 41,5 |
| RENAULT Grand Scénic III, 5-dr MPV, 09– | 41,5 |

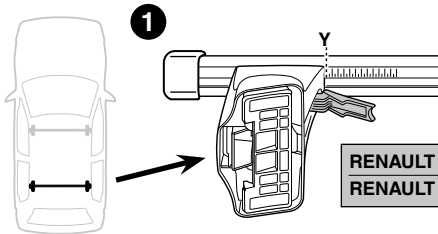
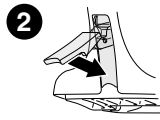

|   | Y    |
|---|------|
| RENAULT Scénic III, 5-dr MPV, 09–       | 40,5 |
| RENAULT Grand Scénic III, 5-dr MPV, 09– | 40,5 |

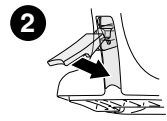
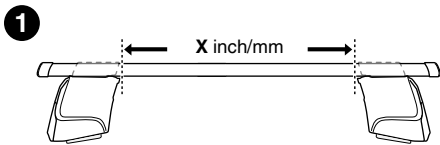
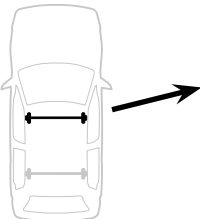
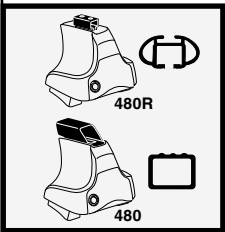
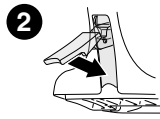

|   | X inch | X mm    |
|---|--------|---------|
| RENAULT Scénic III, 5-dr MPV, 09–       | 42"    | 1066 mm |
| RENAULT Grand Scénic III, 5-dr MPV, 09– | 42"    | 1066 mm |

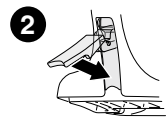
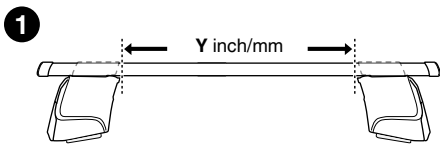
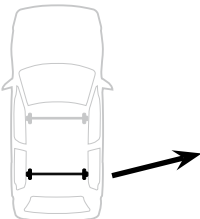

|   | Y inch                           | Y mm    |
|---|----------------------------------|---------|
| RENAULT Scénic III, 5-dr MPV, 09–       | 41 <sup>5</sup> / <sub>8</sub> " | 1056 mm |
| RENAULT Grand Scénic III, 5-dr MPV, 09– | 41 <sup>5</sup> / <sub>8</sub> " | 1056 mm |

4

RENAULT Scénic III, 5-dr MPV, 09–  
RENAULT Grand Scénic III, 5-dr MPV, 09–

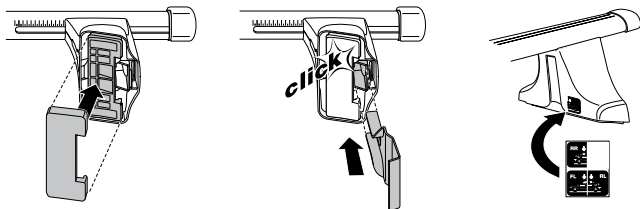
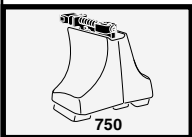
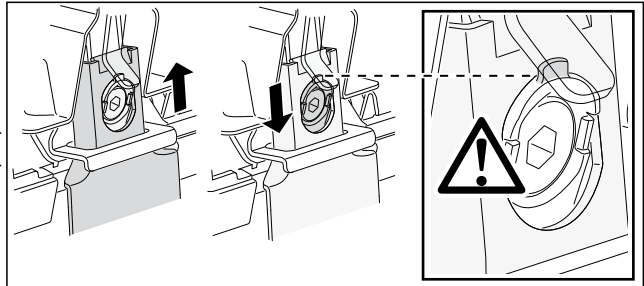
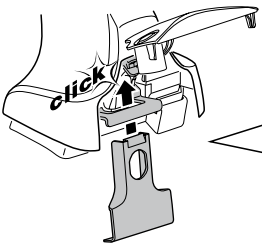
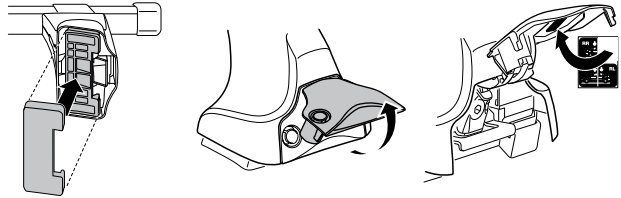
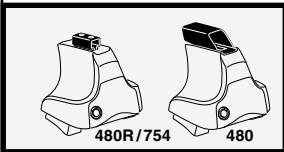
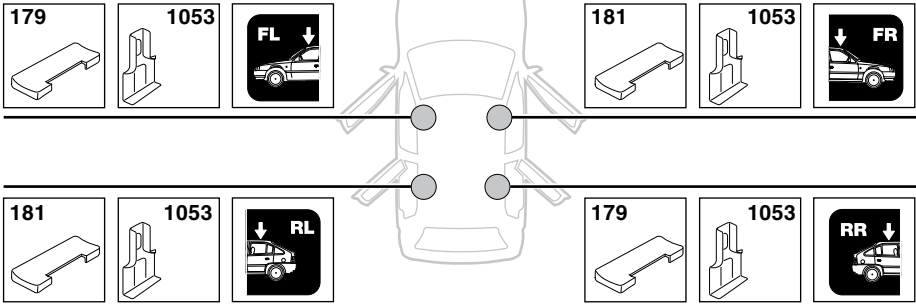

5



|   | X mm  | Y mm   | X inch                           | Y inch                           |
|---|-------|--------|----------------------------------|----------------------------------|
| RENAULT Scénic III, 5-dr MPV, 09-       | 265mm | 730 mm | 10 <sup>3</sup> / <sub>8</sub> " | 28 <sup>3</sup> / <sub>4</sub> " |
| RENAULT Grand Scénic III, 5-dr MPV, 09- | 265mm | 730 mm | 10 <sup>3</sup> / <sub>8</sub> " | 28 <sup>3</sup> / <sub>4</sub> " |

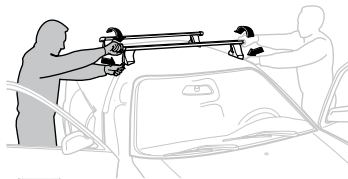
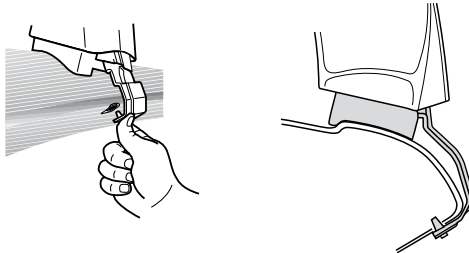
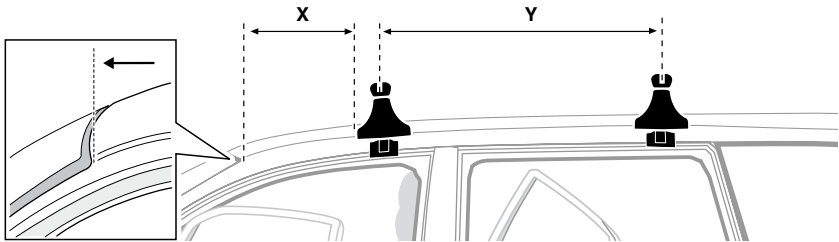

**GB/US** Tighten alternately

**D** Die Schrauben abwechselnd anziehen

**F** Serrer alternativement chaque côté

**NL** Afwisselend aan de linker- en de rechterkant aandraaien

**I** Alternare il serraggio delle viti

**E** Apretar alternativamente

**PT** Aperte alternadamente

**S** Dra åt växelvis

**FIN** Kierrä vuorotellen

**EST** Pinguldage vaheldumisi

**LAT** Pielieciet pamišus

**LIT** Užsukinėkite pakaitomis

**PL** Śruby dokręcaj naprzemiennie

**RU** Затягивайте попеременно

**CZ** Pokręťta bagażníka dokręcaj dokręcaj naprzemiennie.

**SK** Doťahujte striedavo

**SLO** Privijajte izmenično.

**HR** Naizmjenično zategnite

**HU** Egymástól függetlenül szorítandó

**GR** Σφίγγετε εναλλάξ

**TR** Dönüşümlü sıkın

**中文** 交替拧紧

**한국어** 번갈아 가며 조이십시오.

**日本語** 交互に締め付けてください。

**ไทย** ชั้้นโน้แบบสลับ

6



480R/754



480

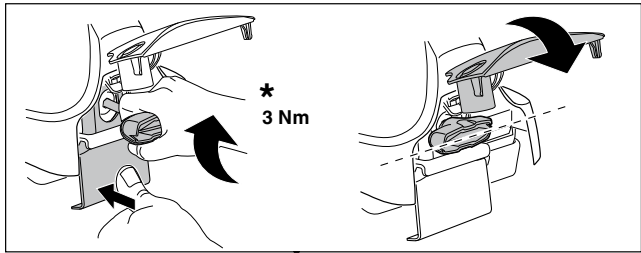

\*  
3 Nm



\*



\*  
≈ 3 Nm

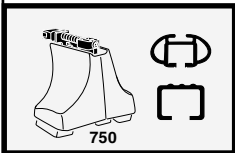
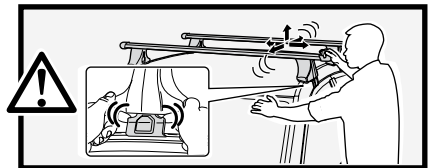

750

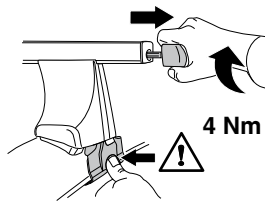

4 Nm

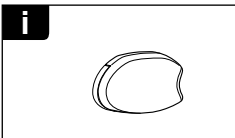
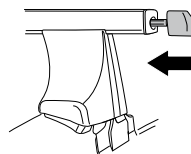

i

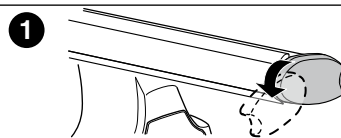

1

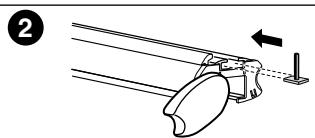

2

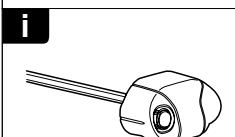

i

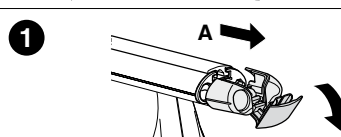

1

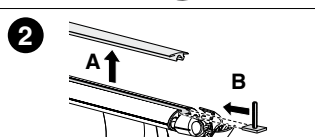

2

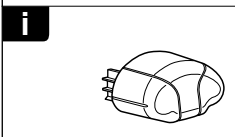

i

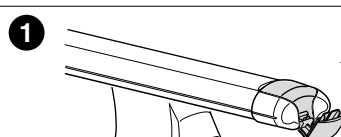

1

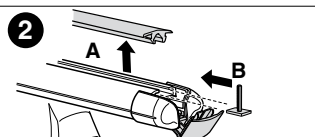

2

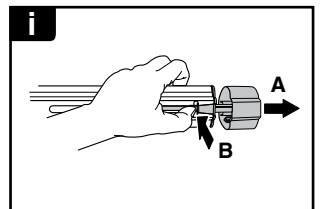
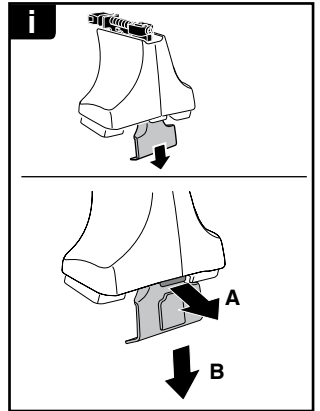

**THULE**  
SWEDEN  
**ONE  
KEY  
SYSTEM**

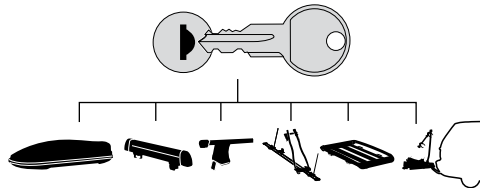

- 544 (x4)
- 596 (x6)
- 588 (x8)
- NA 510 (x10)
- EUR 452 (x12)
- ASIA



WW ▶ Thule Sweden AB, Box 69, 330 33 Hillerstorp, SWEDEN  
NA ▶ Thule Inc., 42 Silvermine Road, Seymour, Connecticut 06483, USA

info@thule.com  
customer.service@thule.com

www.thule.com